

⚠ WARNING: CYCLING CAN BE DANGEROUS. BICYCLE PRODUCTS SHOULD BE INSTALLED AND SERVICED BY A PROFESSIONAL MECHANIC. NEVER MODIFY YOUR BICYCLE OR ACCESSORIES. READ AND FOLLOW ALL PRODUCT INSTRUCTIONS AND WARNINGS INCLUDING INFORMATION ON THE MANUFACTURER’S WEBSITE. INSPECT YOUR BICYCLE BEFORE EVERY RIDE. ALWAYS WEAR A HELMET.

Compatibility & Intended Use



Salsa Casseroll, Colossal, LaCruz Canti, LaCruz Disc, Marrakesh, Vaya, and Warbird forks are intended for ASTM 2 conditions, defined as unpaved and gravel roads and trails with moderate grades. In this set of conditions, contact with irregular terrain and loss of tire contact with the ground may occur. Drops are intended to be limited to 15cm (6”) or less.



Salsa Bearpaw, Cromoto 26”, Cromoto Grande 29er, Enabler, Cutthroat, Firestarter, Makwa Carbon, and Powderkeg Tandem forks are intended for ASTM 3 conditions, defined as rough trails, rough unpaved roads, rough terrain, and unimproved trails that require technical skills. Jumps and drops should not exceed 24” (61cm). They are NOT INTENDED for hardcore freeriding, extreme downhill, dirt jumping, slopestyle, or very aggressive or extreme riding.

IMPORTANT NOTE: Salsa recommends no less than 6mm of clearance between the tire, wheel, fork, and frame.

Tools Required

- Crown race setting tool
- Hammer/mallet
- Hacksaw with a fine 32 tpi tungsten carbide steel blade (alloy/steel steerers)
- Hacksaw blade for carbon (carbon steerers)
- Steerer tube cutting guide (recommended)
- Allen wrenches: 4, 5, 6mm
- Torque wrench that measures in Newton meters

Stem & Headset Preparation

1. Verify that the fork, headset and all required parts for proper assembly have compatible dimensions. The fork, headset, headset spacers, and stem steerer clamp must have compatible diameters. Incompatible components can cause component failure.

Visit headsetfinder.com to verify fork-to-frame compatibility options.

Visit bicycleheadsets.com to learn more about headset fit and the new Standardized Headset Identification System (SHIS).

2. Make sure any stem or headset parts that come into contact with the steerer tube are free of burrs or sharp edges. Remove burrs or sharp edges with fine-grit sandpaper.

⚠ WARNING: Only use rear slot-style clamping stems on carbon steerers. Wedge-clamp stems must not be used and could result in failure (fig. 1).

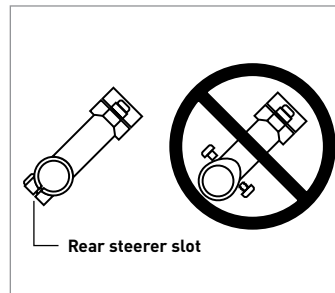

Figure 1

Fork Preparation

1. Install crown race according to manufacturer’s instructions. Do not place the fork on the dropout tips or crown while installing the race, doing so can damage the fork and could cause failure (fig. 2).

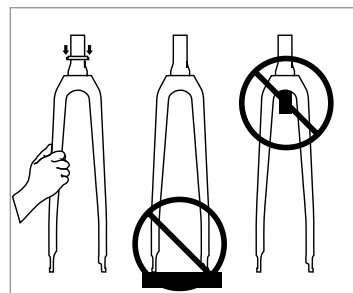

Figure 2

- Assemble the fork, headset and any spacers in the headtube of the bicycle and install the stem (fig. 3).

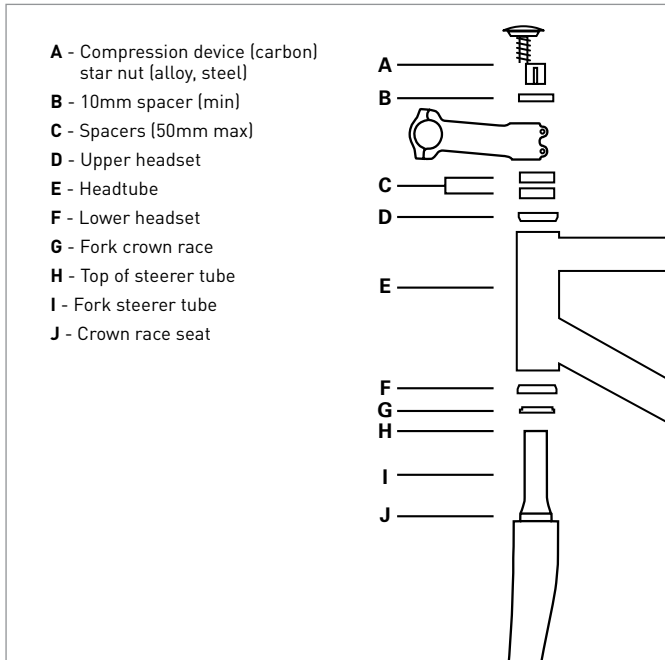

Figure 3

- The spacer stack between the headset and stem must not exceed 50mm (fig. 4).

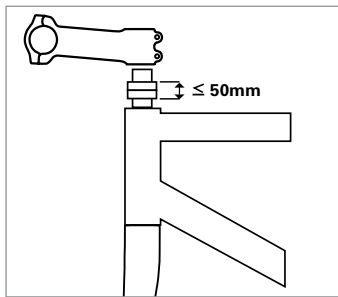

Figure 4

- A carbon steerer tube must extend 7–8mm above the top of the stem clamp and have a 10mm spacer installed between the stem and top cap (fig. 5).

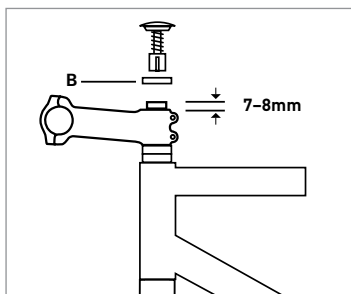

Figure 5

- Carefully measure and mark the amount of steerer tube to be removed. Remember that, when cut, the top of the steerer tube must be 2–3mm below the top of the headset spacer/stem assembly (fig. 6).

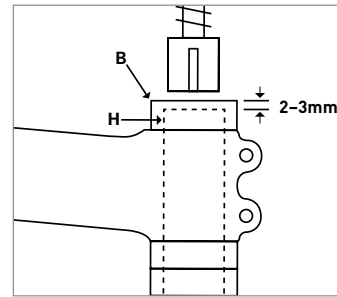

Figure 6

- Remove the fork from the headtube.
- Make certain that you do not cut the steerer tube too short—measure twice, cut once.

CARBON STEERER CUTTING

- Using a new fine-tooth hacksaw blade (preferably a carbon-specific blade) and proper cutting guide, cut the steerer tube.
- Using a synthetic scouring pad, remove burrs and sharp edges.
- Using rubbing alcohol, clean the steerer tube and inside of the stem clamp to remove grease and dirt.

⚠ WARNING: Never use a star nut with a carbon steerer tube fork (fig. 7). Star nuts can only be used with aluminum/steel steerer tube forks. Use only a compression device designed for carbon steerers.

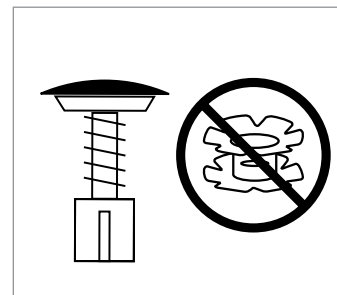

Figure 7

ALLOY/STEEL

- Using a new fine-tooth hacksaw blade and proper cutting guide, cut the steerer tube. A pipe-cutter may be used with aluminum steerer tubes.
- Using fine grit sand paper, remove burrs and sharp edges.
- Using rubbing alcohol, clean the steerer tube and inside of the stem clamp to remove grease and dirt.
- Using a star nut setting tool, install the star nut supplied with your headset into the steerer tube per the headset manufacturer's instructions.

Fork Installation

1. Assemble the fork, headset, headset spacers in the headtube of the bicycle and slide on the stem and 10mm spacer. Insert headset compression adjustment device (compression plug/star nut) into steerer and adjust headset tension using appropriate tool according to the headset manufacturer's instructions. If torque specifications are not provided, tighten to 1.6Nm (15 in-lb).
2. Tighten stem steerer clamp bolts to stem manufacturer's recommended torque specifications.
3. Install and adjust the front brake following the brake manufacturer's instructions.
 - ▲ **WARNING:** Failure to properly install and adjust brakes can result in serious injury.
4. Install the front wheel according to the thru-axle/quick release manufacturer's instructions.
 - ▲ **WARNING:** Failure to properly adjust the quick release or thru-axle to secure the wheel can result in serious injury.

Fork-Mount Bicycle Racks

1. When using a fork-mount (axle dropout-clamping) bicycle rack, always ensure the clamp is closed securely to prevent dropout and/or bike damage. If the clamp is set too loosely the bike can fall out of the rack.
2. When removing the fork from the clamping device make sure to pull/push straight up allowing the dropouts to be removed evenly and at the same time. Do not tilt the bike to remove it from the clamping device, as dropout damage can result (fig. 8).

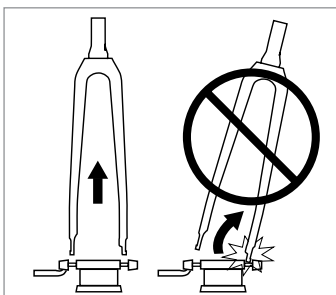

Figure 8

▲ **WARNING:** Dropout damage can cause component failure, which can result in serious injury.

Fender Installation

See separate Fender Installation instructions.

Rack Installation

For this fork to be rack capable it must have lower rack eyelet mounts and mid-blade rack mounts. Please follow the rack manufacturer's instructions for installation. Be sure to use all hardware that came with the rack for installation.

3-Pack Mounts

This fork may have 3-Pack mounts for installing accessories like the Anything Cage or water bottle cages. Please follow your accessories' instructions and weight limits for proper installation.

▲ **WARNING:** Do not exceed the load capacity of 3kg or 6.6 lb for the 3-Pack mounts.

Light Mounting & Cable Routing

▲ **WARNING:** Always check for adequate clearance between the front wheel and any accessory mounted to the fork.

▲ **WARNING:** Entanglement of cables in your wheel could stop the rotation of the wheel causing a loss of control or crash that could lead to serious injury.

Go to salsacycles.com to verify if your fork is light-mount and dyno-mount capable, then please follow the manufacturer's instructions for proper installation. During dyno hub and light mount installation be sure to maintain appropriate clearance (at least 6mm) from anything stationary and rotating mass like the tire. If available, cables should be routed through the internal tube to protect them and keep them from moving into the wheel. Use the appropriate hardware that came with the light to mount it to the fork. Follow the light manufacturer's instructions for proper torque to keep the light from moving or rotating into the wheel.

Ongoing Maintenance

▲ **WARNING:** Do not modify the fork, other than cutting the steerer tube to the correct length for your bicycle. Modifying the fork could cause fork or other component failure resulting in serious injury.

1. Loosen the stem's steerer clamp bolts before making any stem-to-fork alignment adjustments.
2. Periodically remove, clean, and inspect your fork for damage, cracks, or any other damage. Any questions about marks or cracks on the fork should be directed to your Salsa Cycles dealer immediately.
3. Regularly inspect all components for any damage (cracks, chips, etc.) and replace components upon detection.
4. In the event of a crash or impact, carefully inspect handlebars, fork, stem, seatpost, wheels, and the frame for any visible damage. As with any component under varying degrees of stress there is a fatigue life that is proportional to the type of use and abuse applied to the part. Always inspect your components before a ride. If you have doubts about the integrity and condition of any part, replace it. Consult your dealer if you are unsure about the condition of your components or any part of your bicycle.



FORK INSTRUCTIONS

Warranty Registration:

Proof of purchase is required before a warranty claim is processed. Salsa Cycles therefore strongly encourages warranty registration at salsacycles.com. Failure to register will not affect consumer rights so long as the consumer can show, in a reasonable manner, proof of original ownership and the date the Salsa Cycles product was purchased.

If you have any questions contact warranty@salsacycles.com

SALSA CYCLES

6400 West 105th Street, Bloomington, MN 55438

Tel: 877-MOTO-ACE Fax: 952-983-6210

www.salsacycles.com

19188 06/16 | 85-000374_RB

For additional product and safety information go to salsacycles.com/safety