

# XLoc Hose Length Adjustment & Bleed Procedure

Excerpted from  
2010 XX Technical Manual



# XLOC

## TECHNICAL DATA

Material	AL-7075-T6
Hydraulic Fluid	5wt suspension fluid; SRAM Pit Stop™ suspension fluid recommended
Hardware	Titanium
Options	Left / Right side options; Matchmaker X compatible

### XLOC HOSE LENGTH ADJUSTMENT

#### ⚠ CAUTION:

The XLoc damper remote lockout uses a specific hydraulic hose that is compatible with the system's suspension fluid.

- Do **NOT** use hydraulic brake hose to replace the XLoc hydraulic hose. Only use XLoc compatible hydraulic hose.
- Do **NOT** use hydraulic brake fluid or mineral oil in the XLoc system. Only use 5wt suspension fluid.
- Do **NOT** use hydraulic brake bleed tools to bleed the XLoc system. Only use the RockShox Speed Lube Kit.

#### 👉 IMPORTANT:

Always wear safety glasses and rubber gloves when working with suspension fluid.

### PARTS PREPARATION

Parts and tools needed for service:

- Safety glasses
- Rubber Gloves
- Replacement XLoc hydraulic hose
- Hydraulic hose cutter or cable housing cutter
- Sharp knife
- Oil pan

**1** **To reduce the hydraulic hose length:** Use a sharp knife to carefully cut a 1 cm slit in the hydraulic hose across the top of the hose barb at the XLoc remote.

#### 👉 IMPORTANT:

Do not scratch the hose barb. Scratches on the hose barb can cause the XLoc remote to leak.

Pull the cut end of the hydraulic hose from the hose barb.

Use a hydraulic hose cutter or sharp cable housing cutter to cut the hydraulic hose to the desired length.

Firmly press the hydraulic hose back onto the hose barb until the hose bottoms out.

Bleed your XLoc according to the [XLoc bleed procedure](#).

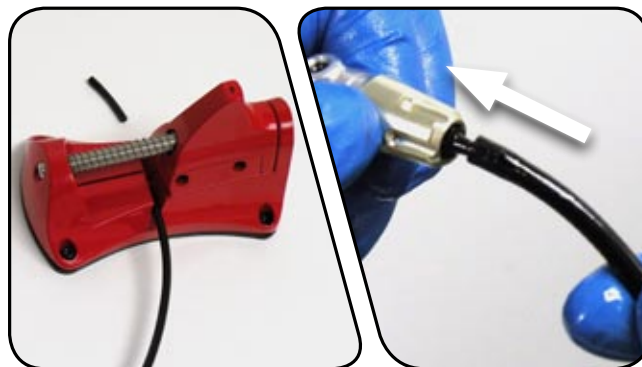
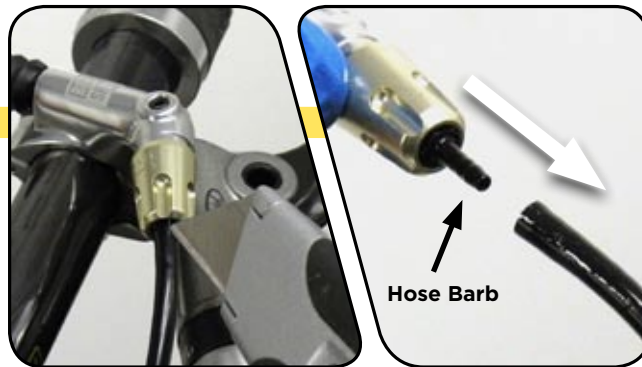

**2 To increase the hydraulic hose length:** Use a sharp knife to carefully cut a slit in the hydraulic hose across the top of the hose barb at the fork crown and the hose barb at the XLoc. Do not scratch the hose barbs.

**IMPORTANT:**

Do not scratch the hose barb. Scratches on the hose barb can cause the XLoc remote to leak.

Pull the hydraulic hose from the hose barbs and discard.

Use a hydraulic hose cutter or sharp cable housing cutter to cut the new hydraulic hose to the desired length.

Firmly press the new hydraulic hose back onto both hose barbs until the hose bottoms out.

Bleed your XLoc according to the [XLoc bleed procedure](#).



## XLOC BLEED PROCEDURE

### **IMPORTANT:**

Always wear safety glasses and rubber gloves when working with suspension fluid.

### **PARTS PREPARATION**

Parts and tools needed for service:

- Safety glasses
- Rubber Gloves
- T25, T10 TORX® wrenches
- Torque wrench
- SRAM Pit Stop 5wt suspension fluid
- RockShox Speed Lube Kit

**1** Use a T25 TORX wrench to unthread the shifter mounting bolt and remove the shifter.



**2** Use a T25 TORX wrench to loosen the XLoc handlebar clamp, position the XLoc so that the bleed screw is slightly above the button, and re-tighten the clamp bolt.



**Bleed screw**



**3** Press the XLoc button to set it to the 'Locked' position (button fully extended). Turn the gold Floodgate adjuster in the direction of the arrow until it stops (maximum Floodgate).



**4** Assemble two RockShox Speed Lube Kit syringes:

Install an o-ring onto the end of the brass fitting. Insert the brass fitting into the plastic tube. Insert the red fitting into the other end of the plastic tube. Thread the red fitting into the syringe.

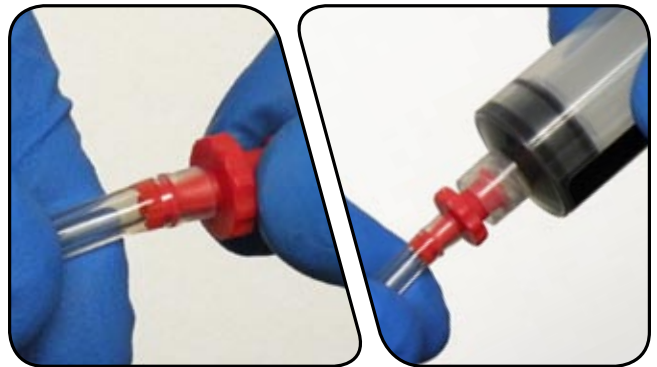
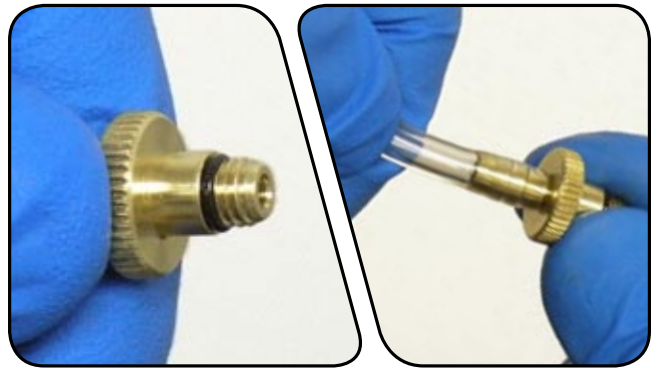

**5** Use a T10 TORX wrench to remove the bleed screw from the top of the damper, located at the fork crown.



**6** Fill both Speed Lube syringes with 10 ml of 5wt suspension fluid.



**7** Thread the brass fitting of one of the suspension fluid-filled Speed Lube syringes into the damper bleed port.



**8** Gently push in the syringe plunger to fill the system with suspension fluid.

Reverse this process by gently pulling out on the syringe plunger.

Repeat these steps a few times to ensure the system is fully filled with suspension fluid.



**9** Use a T10 TORX wrench to remove the bleed screw from the XLoc.



**10** Apply a few drops of suspension fluid to the XLoc bleed port, and then thread the brass fitting of the other speed lube kit into the bleed port.

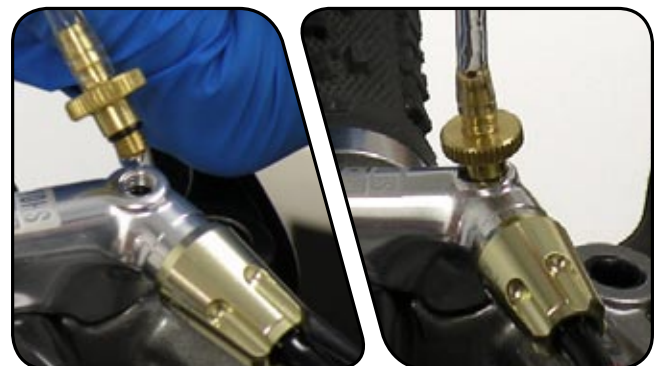

**11** Hold both syringes upright and depress the plunger of the damper syringe while simultaneously pulling out on the plunger of the remote syringe. Reverse this process and repeat until no more bubbles move into the remote syringe.

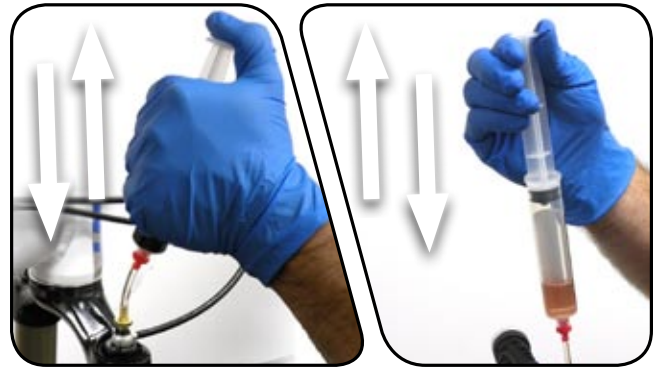

**12** Unthread the syringe from the damper, and use a T10 TORX wrench to re-install the bleed screw into the damper. Use a rag to wipe off any excess suspension fluid.



**13** Hold the XLoc button in the extended (locked) position and pull out the syringe plunger. Small bubbles will move into the suspension fluid as air is pulled from the system.

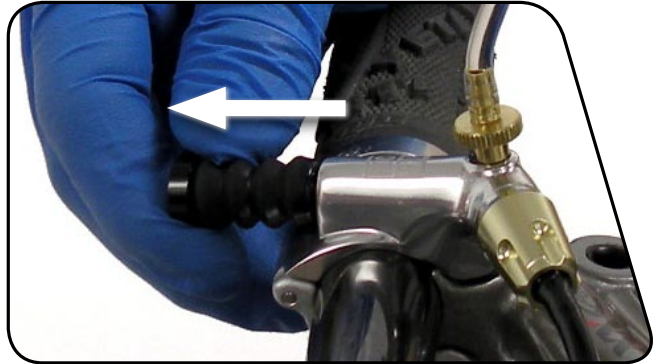

**14** Continue pulling out on the Speed Lube syringe plunger. Push in the XLoc button to the unlocked position. This will dislodge more bubbles from the remote into the syringe.

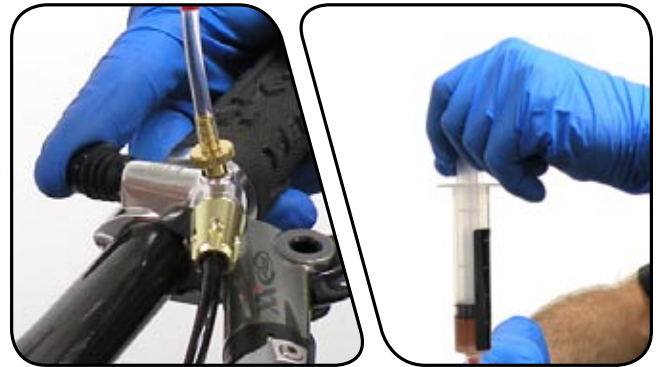

**15** Push in on the syringe plunger, and then press in the XLoc button to release it to the locked position. t

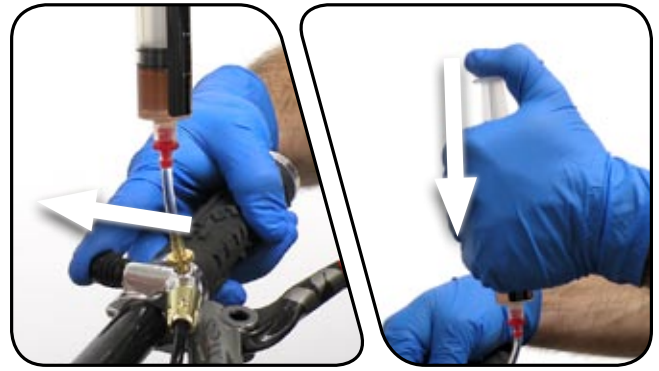

**16** Repeat steps 13-15 until air bubbles no longer move into the suspension fluid. It can take several repetitions of this process to fully void the system of air.

**17** Unthread the Speed Lube fitting from the XLoc bleed port. Put a few drops of suspension fluid into the bleed port. Replace the bleed port screw and use a T10 TORX wrench to torque to 0.5-0.7 N·m (4.5-6 in-lb). Use a rag to wipe off any excess suspension fluid.

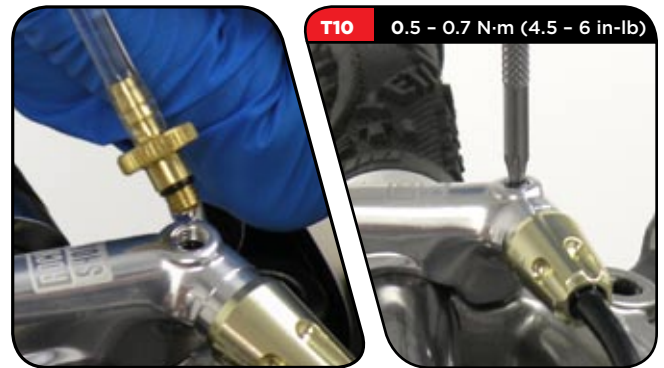

**18** Use a T25 TORX wrench to loosen the XLoc handlebar clamp. Re-position the XLoc to your desired angle. Use a T25 TORX wrench to torque the XLoc clamp bolt to 5-6 N·m (44-53 in-lb).



**19** Attach the XLoc shifter to the XLoc bracket with the shifter mounting bolt. Use a T25 TORX wrench to torque the shifter mounting bolt to 2.8-3.4 N·m (25-30 in-lb).

