

Item Description	VPN	Barcode	Size	First Available
Ascend 100mm Dropper Seatpost	BRNDXDRP01357309100	5057567108996	30.9mm x 357mm 100mm	Jul-21
Ascend 100mm Dropper Seatpost	BRNDXDRP01357316100	5057567108989	31.6mm x 357mm 100mm	Jul-21
Ascend 125mm Dropper Seatpost	BRNDXDRP0123412316125	5056305557270	31.6mm x 412mm 125mm	Mar-20
Ascend 125mm Dropper Seatpost	BRNDXDRP0123412309125	5056305557263	30.9mm x 412mm 125mm	Mar-20

Brand-X Ascend 100, 125mm Internal Route Dropper Post – 2020 version Disassembly, Maintenance and Reassembly

Thanks for buying a Brand-X Ascend dropper post.

Regular maintenance is important to ensure continued function and longevity of your post. This guide will take you through the steps required to fully disassemble and then reassemble your dropper post. We used a 31.6/125mm travel/412mm length dropper post to demonstrate the steps.

Tools you'll need:

- 2mm, 3mm and 5mm Allen Keys
- 10mm socket and driver
- 16mm Spanner
- Pick or sharp flat head screwdriver
- Pliers
- Torque Wrench
- Ascend Dropper Seatpost Assembly Grease
- Relevant Maintenance Kit if required (includes upper and lower bushing, collar seal, retaining ring and brass keys)
- New cartridge if required (size specific and so select the correct one if you're planning on changing your cartridge)



Disassembly



1. Using a 5mm allen key remove the seat clamp.



2. Using a 16mm spanner remove the actuator head, turning it clockwise.



3. Undo the two grub screws to detach the actuator from the cartridge.

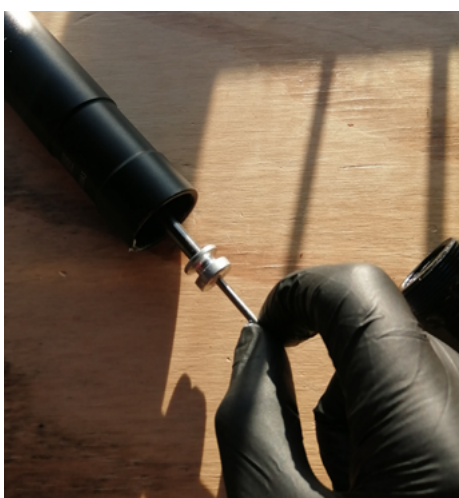

4. Remove the actuator pin from the cartridge - you should be able to pull this out with your fingers.



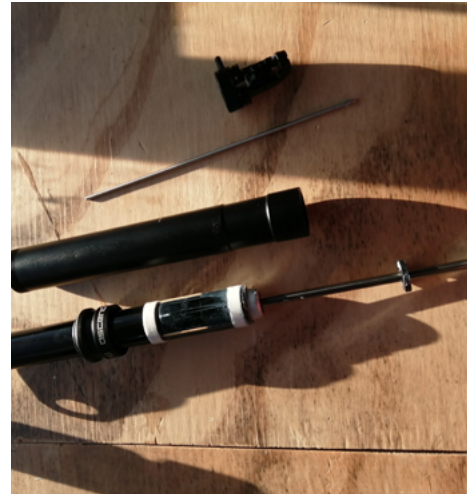

5. Unscrew the collar and remove the stanchion from the post.



6. Delicately remove the upper and lower bushing and collar. Note the orientation of the lower bushing. This is important for reassembly.

7. Using a pick or a sharp flat headed screwdriver gently lift the brass pins.

8. Remove the collar.



9. Disassemble the collar - remove the metal retaining ring and then lift out the rubber seal.



10. Using a 10mm socket, remove the cartridge from the stanchion. Put a rag round the cartridge and clamp it with a pair of pliers, then undo the nut at the top of the post with your socket. Remove the cartridge from the stanchion.

Your post is now fully disassembled. Inspect it for damage, remove dirt and old grease and replace parts where required.

Assembly



1. Insert the cartridge into the stanchion and fit the nut into the head of the stanchion. Clamp the cartridge with a rag and pair of pliers and tighten the nut with your 10mm socket.

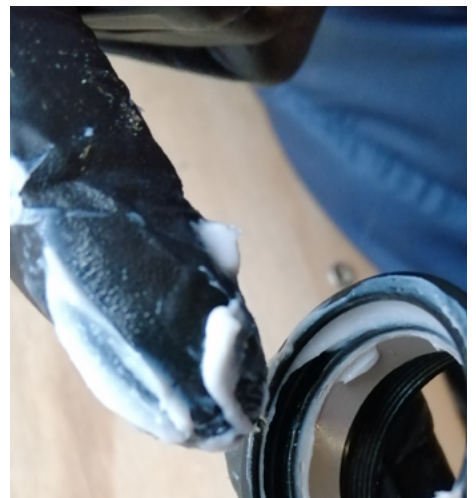

2. Lightly grease the inside of the collar.



3. Insert the seal back into the collar (don't yet fit the metal retaining ring).



4. Slide the metal retaining ring on to the seat post stanchion.



5. Feed the collar on to the seat post stanchion - check the seal has not curled over and is uniform and in place on the collar.



6. Push the metal retaining ring on to the seal.



7. Grease the lower stanchion and fit the upper and lower bushing. Note the ridged bushing is the lower and the smooth is the upper.



8. Grease the inserts for the keys and insert these firmly into their slots.



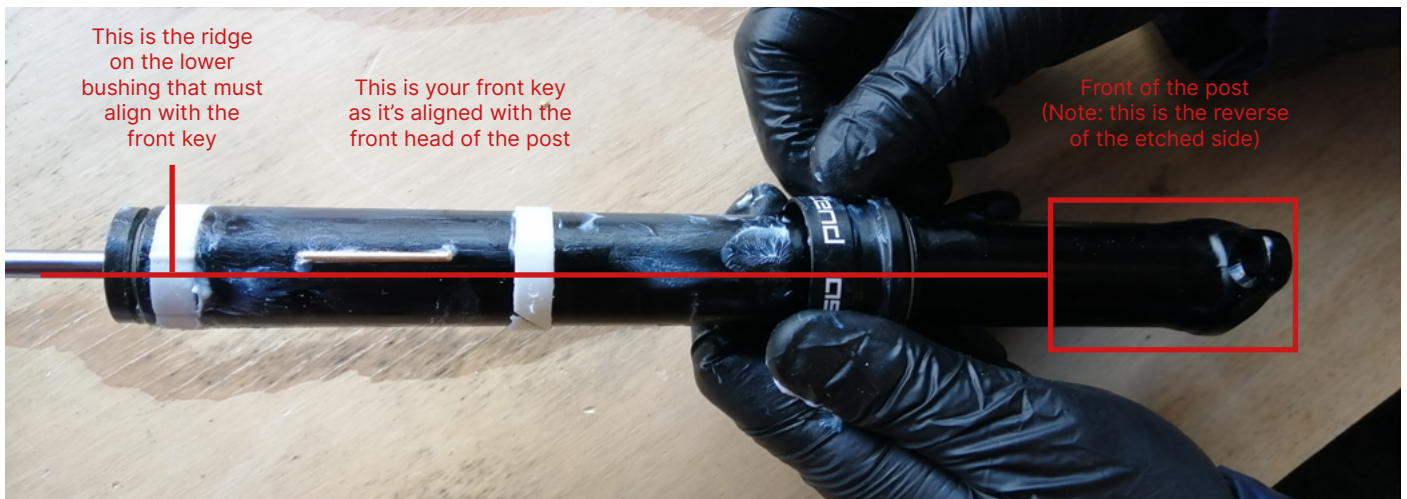

9. Align the ridge on the lower bushing to the front key.



10. Lubricate the inner of the seat post tube.

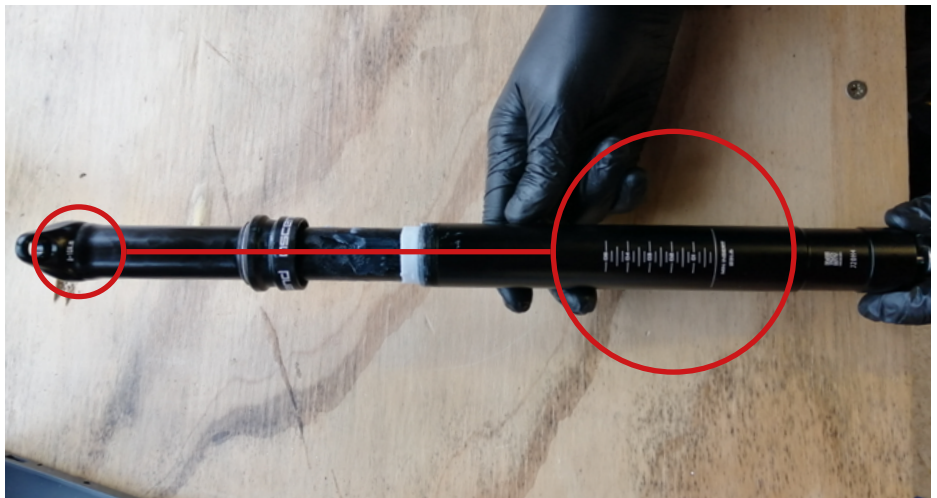

11. Insert the stanchion into the seat post tube. To guarantee alignment you can match up the laser etchings from the minimum insert markings on the seat post tube to the markings on the rear of the stanchion.

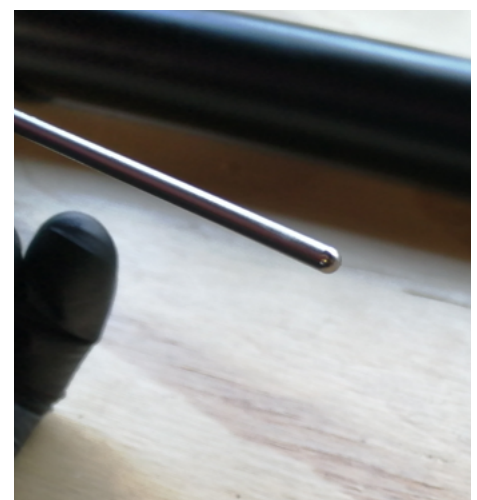

12. Push bushing into place, slide collar into place and tighten.

13. Insert the actuator pin into the cartridge – note the pin is directional and that the rounded end should face out of the cartridge.

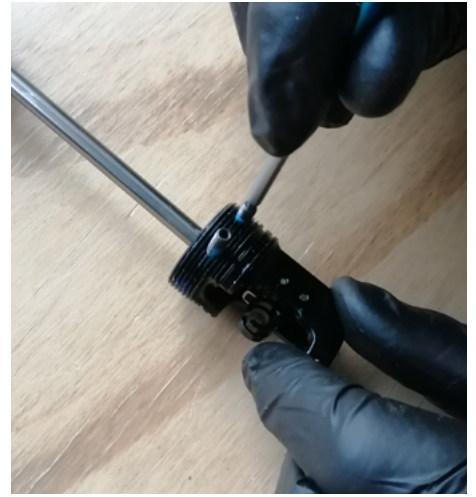

14. Fit the actuator back on to the cartridge and tighten the grub screws. Ensure the cartridge is correctly seated into the actuator. Ideally add a little Loctite 243 to the grub screws to guarantee secure fitment if there is no threadlock compound left on them.



15. Push the actuator and cartridge into the base of the post and tighten with a spanner to 8Nm. You can use the shaft of a 5mm allen key through the actuator to help push it down.



16. Reassemble the saddle clamps.

17. Check the function of the post before fitment. You can do this by pulling on the actuator link and simultaneously pushing the post down to depress it. With the dropper fully dropped pull the actuator and the post should lift.